

1 Bed

- Apartment Area 46.7sq.m (45sq.m minimum required)
- Aggregate Living/Dining/Kitchen area 23 sq.m (23sq.m minimum but variation of up to 5% can be applied to room areas subject to overall compliance with required minimum overall apartment floor area)
- Storage Area 3.1sq.m (3sq.m minimum required)
- Amenity Space (Wintergarden) 8.3sq. m (5sq. m minimum)

L27 - Apartment Type E
1 : 50

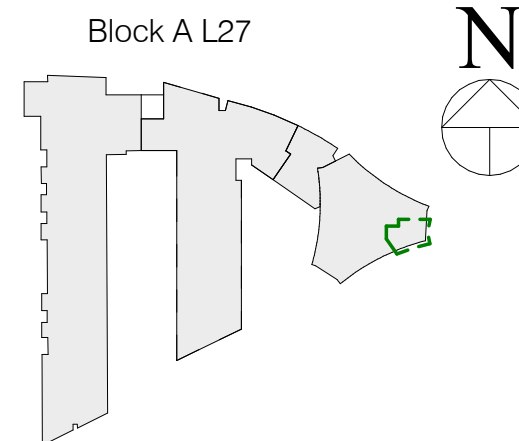

Notes:

- Do not scale from this drawing. Use figured dimensions in all cases.
- Verify dimensions on site and report any discrepancies to the Architect immediately.
- This drawing to be read in conjunction with the Architect's Specification.
- © This drawing is copyright and may only be reproduced with the Architect's permission.

| Rev. | Date | Drwn | Details of Issue / Revision |
|------|------------|------|-----------------------------|
| P01 | 20.03.2026 | RAU | Issued for Planning |

Issues & Revisions



Dartry Mills,
 Dartry Road
 Dublin 6,
 D06 Y0E3
 T: +353 (0)1 498 7000
 W: www.reddyarchitecture.com
 E: info@reddyarchitecture.com

Client Details:

Ruirside Developments Ltd

Project Details:

**Parkgate St
42a Parkgate St, Dublin 8**

Drawing Title:

Application 01 - Proposed Apartment type E

| Job No. | Sheet Size: | Scale @A3 |
|-----------------|---------------------|---------------------|
| P24-216D | A3_Landscape | As indicated |
| Issue Date: | Drawn By: | Reviewed By: |
| 20.03.2026 | RAU | PK |

| Status | Purpose of Issue |
|-----------|----------------------------|
| S0 | Planning Permission |

| Project - System - Spatial Zone - Level - Type - Originator - Role - Number | Revision |
|---|------------|
| PGS-02-SW-ZZZ-DR-RAU-AR-5005 | P01 |